



RECYCLED PACKAGING

8800



## **PREFACE**

Thank you for purchasing our dual band portable two way radio. This easy-to-use radio will deliver you secure, instant and reliable communications at peak efficiency. Please read this manual carefully before use. The information presented herein will help you to derive maximum performance from your radio.

## Contents

---

<b>Unpacking and Checking Equipment</b> .....	01
<b>Product Overview</b> .....	02
<b>Function Keypad</b> .....	03
<b>Before Use</b> .....	05
Charging the Battery Pack .....	05
Charger LED indicator and charging status .....	05
USB Charging .....	06
Battery LED Indicator and battery status .....	06
<b>Preparation</b> .....	07
Installing/Removing the Antenna .....	07
Installing/Removing the Belt Clip .....	07
Installing/Removing the Battery .....	07
Installing the Optional Speaker/Microphone(or Headset) .....	08
<b>Status Indication</b> .....	08
LED Indicator .....	08
<b>LCD Icons</b> .....	09
<b>Basic Operations</b> .....	10
<b>Menu Functions</b> .....	13
<b>Troubleshooting</b> .....	15
<b>Care and Cleaning</b> .....	17

## Unpacking And Checking Equipment

---

Carefully unpack the transceiver. We recommend that you identify the items listed in the following table before discarding the packing material. If any items are missing or have been damaged during shipment, please contact the carrier or the dealers immediately.

### Supplied Accessories

Item	Quantity
Antenna	1
Li-polymer Battery	1
Charger	1
Adaptor	1
Belt Clip	1
Hand Strap	1
User Manual	1

#### Note:

If you need to know more information about optional accessories. Please contact us.

## Product Overview

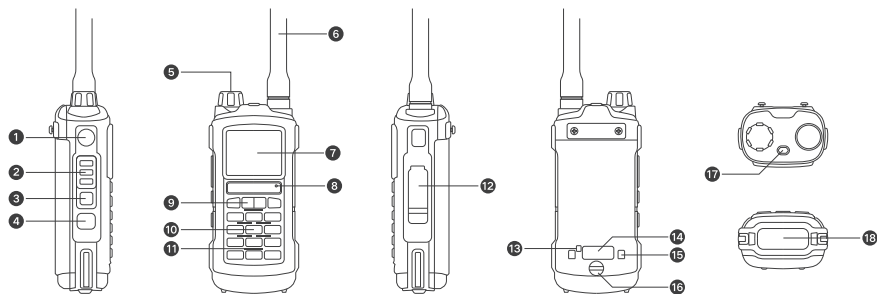

No.	Part Name	No.	Part Name	No.	Part Name
1	PF1 Key (LAMP Key)	7	LCD Display	13	Charging Indicator
2	PTT-1	8	Microphone	14	USB Charging Port
3	PTT-2	9	Function Keypad	15	Battery Contacts
4	PF2 Key (Programmed Key)	10	Numeric Keypad	16	Battery Screw
5	Power On/Off Volume Knob	11	Speaker	17	LED Indicator
6	Antenna	12	Accessories Jack	18	Flashlight

## Function Keypad

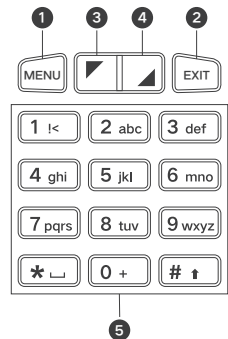

No.	Key	Function
1	[ MENU ]	Menu/Enter Key
2	[ EXIT ]	Exit/Delete Key Switch A/B Band in standby mode
3	[ UP ]	Press for 2 Seconds to up rapidly Change the Scan direction in scan status
4	[ DOWN ]	Press for 2 Seconds to down rapidly Change the Scan direction in scan status
5	[ Numeric Keypad ]	In Standby status: Input frequency in VFO mode Input channel number in Channel mode In Transmitting status: Input DTMF Code in transmitting status

## Function Keypad

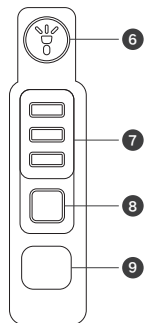

No.	Key	Function
6	【 PF1 】	LAMP Key, Short press to turn on/off flashlight Long press for emergency alarm
7	【 PTT-1 】	Press PTT-1 key to transmitting A Band
8	【 PTT-2 】	Press PTT-2 key to transmitting B Band
9	【 PF2 】	Short Press: TX Power/Monitor/Scan Long Press: TX Power/Monitor/Scan Default: TX Power Note: PF2 Key can be setup in PC software.

## Before Use

### ■ Charging the Battery Pack

Use only the charger and battery specified by the manufacturer. The charger LED indicates the charging progress.

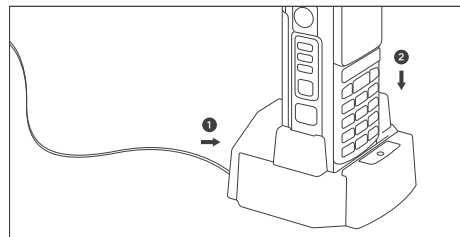

- As ① shown, Plug the AC adaptor into the AC outlet, and then plug the cable of the AC adaptor into the DC jack located on the back of the charger.
- As ② shown, Plug the radio into the charger. Make sure the battery terminals are good in contact with charging terminals.

- The indicator light turns to red, the charging begins.
- The indicator light turns to green, the charging is completed.

### ■ Charger LED indicator and charging status

LED indication	Charging status
Constant Green	Standby (no-load)
Constant Red	Charging
Constant Green	Fully charged

## Before Use

### ■ USB Charging

Use only the USB charging cable specified by the manufacturer. Charger LED can indicate the charging status.

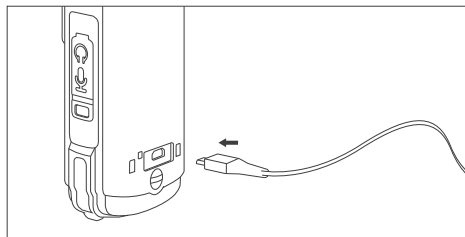

1. Plug the USB charging cable into the charging port on the back of the battery.
2. The indicator light turns to red, the charging begins.
3. The indicator light turns to green, the charging is completed.

### ■ Battery LED Indicator and battery status

LED indication	Charging status
Constant Red	Charging
Constant Green	Fully Charged

## Preparation

### Installing/Removing the Antenna

Screw the antenna into the connector on the top of the transceiver by holding the antenna at its base and turning it clockwise until secure. Note: Turn the antenna counter-clockwise until you can remove it.

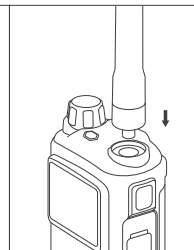

### Installing/Removing the Belt Clip

1. Attach the belt clip above the corresponding holes on the back of the radio, and screw it clockwise with the two supplied screws.
2. Loosen the screws to remove the belt clip.

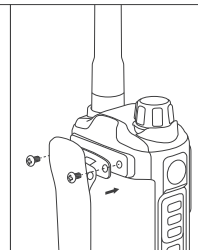

### Installing/Removing the Battery

1. Match the two top grooves of the battery pack on the back of the radio and then push it.
2. Screw it clockwise to install the battery.
3. Unscrew counter-clockwise to remove the battery.

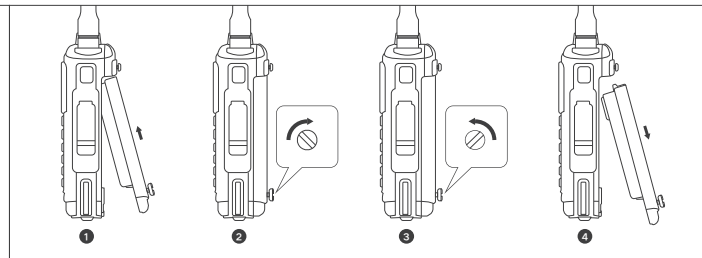

## Preparation

### Installing the Optional Speaker/Microphone(or Headset)

Insert the speaker/microphone (or headset) plugs into the speaker/microphone jacks.

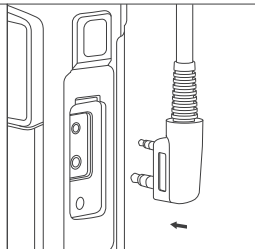

## Status Indication

### LED Indicator

The top LED indicator will help you easily identify current radio status.

Radio Status	LED Indicator
Transmitting	LED glows red
Receiving	LED glows green

## LCD Icons

Icon	Radio status
	Signal Strength Level
	Low Power
	High Power
	DTMF activated
	CTCSS activated
	DCS activated
	Position: TX frequency = RX frequency + Offset frequency
	Negative: TX frequency = RX frequency - Offset frequency
	Dual watch/ dual reception functions activated
	Keypad lock function activated. Press [ * ] Key for 2 Seconds to unlock the keypad
	VOX function enabled
	Narrow Band selected
	Battery Level indicator
	A/B Band Direction, Operation frequency
	Bluetooth programming function activated

## Basic Operations

---

### Powering On/Off

Turn the [ Power/Volume knob ] clockwise to switch the transceiver power ON till a click is heard.

### Adjusting the Volume

Rotate the [ Power/Volume knob ] to adjust the volume. Turn clockwise to increase the volume and counter-clockwise to decrease the volume.

### Enter/Exit Menu

Short Press [ MENU ] Key to enter menu, and press [ UP/DOWN ] key to select the function. Press [ MENU ] Key to confirm, Press [ EXIT ] to exit.

### A/B Band Switch

In standby, press [ EXIT ] Key to switch A/B Band. Main Band marked with  $\Delta$ .

### Dual PTT

Press [ PTT-1 ] to transmit in A Band.  
Press [ PTT-2 ] to transmit in B Band.

### VFO/Channel Switch

In standby, long Press [ MENU ] Key to switch between VFO and channel mode.  
If the channel list does not have a valid channel number, you cannot switch to channel mode.

### Side Key

To program the side key function via program software.  
Side key functions include: FM Radio/ Power Switch/Monitor/Scan/Search Frequency.

### Battery Voltage

In standby, long press [ 0 ] Key to check the current battery voltage.

### Keypad Lock/Unlock

In standby, long press [ \* ] Key to lock/unlock keypad.

### Dual Standby

After turn on dual standby function, you can wait two channels signals from Band A and Band B at the same time.

## Basic Operations

---

Operation: Menu-- Setting- Dual Standby

### VOX

This function is not necessary to push the PTT on the transceiver for a transmission. Transmission is activated automatically by detecting the radio voice. When finish speaking, the transmission automatically terminated and the transceiver will automatically receive signal. Be sure to adjust the VOX Gain level to an appropriate sensitivity to allow smooth transmission.

Operation: Menu---VOX Level--OFF/1/2/3

### VOX Delay

When the VOX is enabled, set up the VOX delay to help to extend the transmission time to avoid stopping a transmission too early.

Operation: Menu-- Setting-- VOX Delay---0.5~2S

### SOS

SOS function support three modes: On site/Send sound/Send code.  
On Site: The radio emits an alarm tone and does

not send out signals to others.

Send Sound: Transmit the alarm sound through the signal.

Send Code: Transmit the alarm code through the signal.

Operation: Long press PF1(flashlight key) to turn on SOS mode.

Radio Setting: Menu-- Setting --SOS mode.

### Flashlight

Short press PF1 to turn on/off flashlight.

### Scan

In standby, long press [ # ] key to turn on scan function, it support channel list scan and frequency steps scan.

Operation: Menu--Setting--Scan mode--Time/-Carrier/Search.

Time Operation (TO): Scanning will stop when it detects an active signal, and after 5s, it resumes scanning.

Carrier Operation(CO): Scanning will stop when it detects an active signal, until the active signal disappears, and after 5s, It resumes scanning.



## Basic Operations

Search Operation(SE): Scanning will stop after it detects an active signal.

Note: In channel mode, scanning the channel numbers in the channel list. In frequency mode, scanning in frequency steps.

### PTT-ID

This feature allows you to know who call you.

Transmit ANI code or DTMF code through DTMF. DTMF code total 15 groups.

In the PC software--Edit--DTMF setting, each signal or A/B band can independently select the call code group to be sent.

In the PC software--Edit--DTMF--ANI Code to set ANI code.

Press to Send ---Transmit the code while push the PTT button.

Release to Send---Transmit the code while release the PTT button.

BOTH---Transmit the code while push or release the PTT button.

Note: Since the ANI code operation is independent of the DTMF code. If the ANI code conflicts with the DTMF code setting, the ANI code is sent.

## Menu Functions

Menu	Function/Description	Available settings
Radio Set	SQL(Squelch Level)	Level 0/1/2/3/4/5
	Transmit Power	High/Low
	Bandwidth	Wide 25K/Narrow 12.5K
	Busy Channel Lockout	ON/OFF
	TOT(Trans over time)	OFF/30/60/90/120/150/180/210/240s
VOX Level	Voice Operated Transmission	OFF/Level1/2/3
Setting	Battery Save	ON/OFF
	Dual Standby	ON/OFF
	SOS Mode	On Site/ Send Sound/Send Code
	Scan Mode	Time/Carrier/Search
	Back Light Time	Bright/5s/10s/15s/20s/30s/1min/2min/3min
	Beep Prompt	ON/OFF
	VOX Delay	0.5S/0.6S/....2.0S
	Menu Exit Time	5S/10S/15S...60S
	Keypad Auto Lock	ON/OFF
CTCSS/DCS	Receive CTCSS	OFF/67.0HZ...241.HZ

## Menu Functions

Menu	Function/Description	Available settings
CTCSS/DCS	Receive DCS	OFF/D023N...D754I
	Transmit CTCSS	OFF/67.0HZ...241.HZ
	Transmit DCS	OFF/D023N...D754I
	Encryption	ON/OFF
Frequency Mode	Step	2.50/5.00/6.25/10.00/12.50/25.00/50KHz
	Direction	None/Plus/Minus
	Offset	00.000....69.990MHz
Channel Storage	CH-Memory	000,CH-001....CH-127
	CH-Delete	000,CH-001....CH-127
	CH-Edit Name	Name display can be set by PC software
Frequency	Rx: 136-174 / 400-470MHz , Tx: 144-148 / 420-450Mhz	
Reset	VFO Mode	Delete all the setting in VFO mode
	Reset All	Delete all settings

## Troubleshooting

If the solutions below cannot fix the problems for you, or you may have some other queries, please contact us or your local dealer for more technical support.

Phenomena	Analysis	Solution
Power-on Failure	The battery may be improperly installed.	Remove the battery and reassemble it.
	The battery power may be used up.	Recharge or replace the battery.
During receiving, the voice is weak, discontinuous or totally inactive.	The battery is poorly connected due to dirtied or damaged battery contacts.	Clean the battery contacts. If the problem cannot be solved, contact your dealer or authorized service center for inspection and repair.
	Low battery voltage.	Recharge or replace the battery.
	Low volume level.	Increase the volume by rotating the Volume Control knob.
	The antenna may be loosened or improperly installed.	Reassemble the antenna after turning off the radio.
Unable to communicate with other members.	The speaker may be blocked or damaged.	Clean the surface of the speaker. If the problem cannot be solved, contact your dealer or authorized service center for inspection and repair.
	The frequency or signaling may be inconsistent with that of other members.	Set your TX/RX frequency and signaling to the same as that of other members.
	The channel type (digital/analog) may be set inconsistently.	Make sure all members are on the same digital/analog channel.

## Troubleshooting

Phenomena	Analysis	Solution
Unable to communicate with other members.	You may be too far away from the group members.	Move towards other members.
Irrelevant communication or noise is heard on the channel.	You may be interrupted by radios using the same frequency.	Change the frequency, or adjust the squelch level.
	The radio may be set with no signaling.	Set signaling for all member radios to avoid interference at the same frequency. And change the signaling settings for all portable radios at the same time.
The noise is too loud.	You may be too far away from other members.	Move towards other members.
	You may locate in an unfavorable position. For example, your communication may be blocked by high buildings or frustrated in the underground areas.	Move to an open and flat area, and restart the radio to try again.
	You may suffer from external disturbance (such as electromagnetic interference).	Stay away from equipment that may cause interference.

## Care and Cleaning

To guarantee optimal performance as well as a long service life of the product, please follow the tips below.

- Do not puncture or scratch the product with hard objects.
- Do not place the product in corrosive agents, solutions or water.
- Do not handle the radio by its antenna or external microphone directly.
- When not in use, keep the accessory jacks covered with the protective caps.



**Power off the product, and remove the battery before cleaning.**

- Clean up the dust and fine particles on the product parts with a clean and dry lint-free cloth or a brush regularly.
- Use a non-woven fabric with neutral cleanser to clean the keys, control knobs, and shell after long-time use. Do not use chemical preparations such as stain removers, alcohol, sprays or oil preparations.
- Make sure the product is completely dry before use.

## Care and Cleaning

---

NOTE: This equipment has been tested and found to comply with the limits for a Class B digital, pursuant to part 15 of the FCC Rules. These limits are designed to provide reasonable protection against harmful interference in a residential installation. This equipment generates uses and can radiate radio frequency energy and, if not installed and used in accordance with the instructions, may cause harmful interference to radio communications. However, there is no guarantee that interference will not occur in a particular installation. If this equipment does cause harmful interference to radio or television reception, which can be determined by turning the equipment off and on, the user is encouraged to try to correct the interference by one or more of the following measures:

- Reorient or relocate the receiving antenna.
  - Increase the separation between the equipment and receiver.
  - Connect the equipment into an outlet on a circuit different from that to which the receiver is connected.
  - Consult the dealer or an experienced radio/TV technician for help.
- changes or modifications not expressly approved by the party responsible for compliance could void the user's authority to operate the equipment. This device complies with Part 15B of the FCC Rules. Operation is subject to the following two conditions:
- (1) this device may not cause harmful interference, and
  - (2) this device must accept any interference received, including interference that may cause undesired operation.